

Issue: 1	Date
Drawn	22/02/2021
Checked	22/02/2021
Approved	22/02/2021

Client: Sapphire Utility	Site: B6221, Wash Lane Bury BL9 7DA
Project : Road Closure Diversion	
Original drawing size A4 - NTS	

Drawing No :	SA-759040
Works Ref No:	WO 00427526

This drawing is the property of Sapphire TM Ltd. reproduction in part or in whole is prohibited without prior permission from Sapphire Utility Ltd.

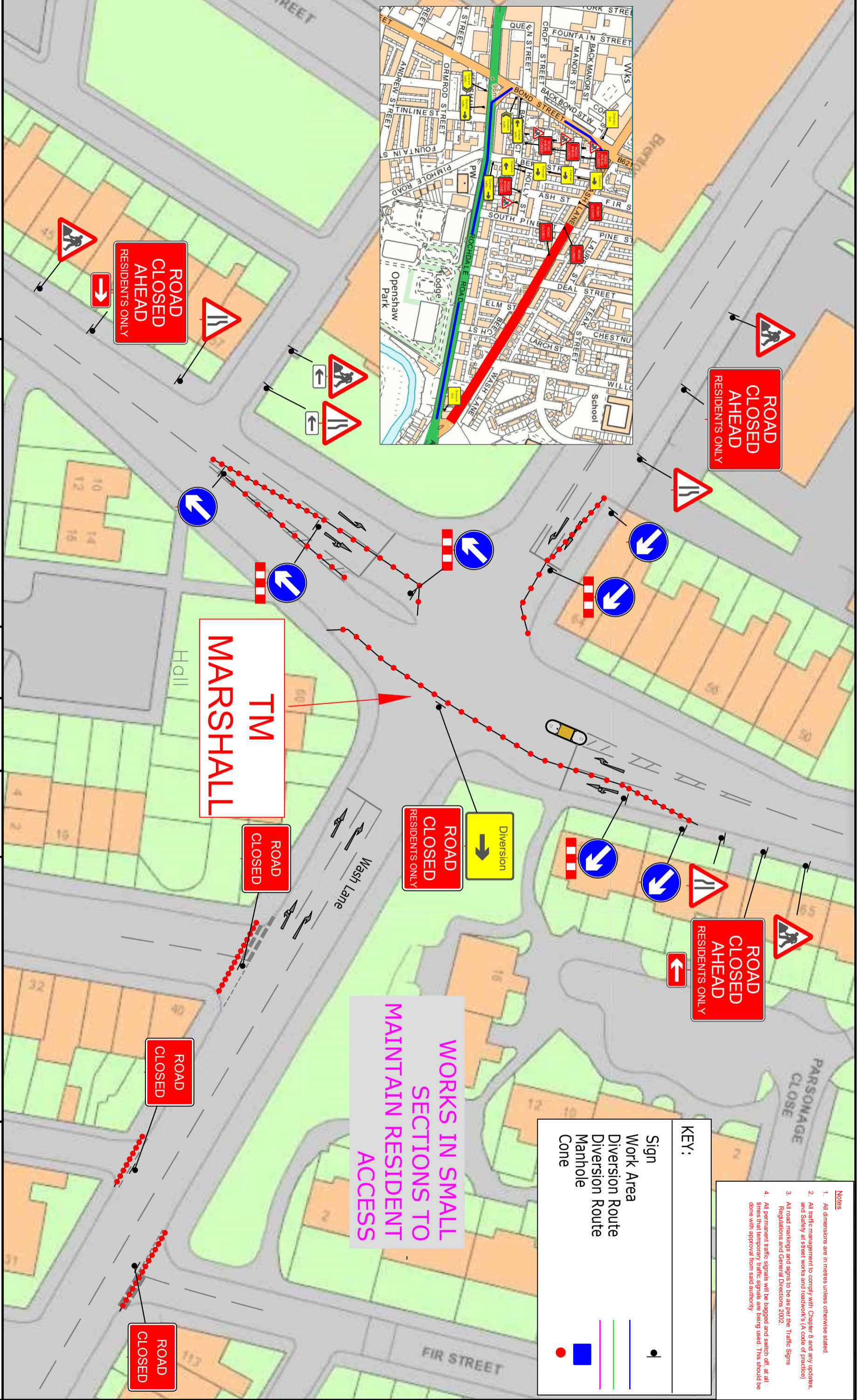

- Notes**
1. All dimensions are in metres unless otherwise stated.
 2. All traffic management to comply with Chapter 8 and any updates, and safety at street works and roadworks (A code of practice)
 3. All road markings and signs to be as per the Traffic Signs Regulations and General Directions 2002.
 4. All permanent traffic signals will be bagged and switch off, at all times that temporary traffic signals are being used. This should be done with approval from said authority.

KEY:

Sign	●
Work Area	■
Diversion Route	—
Diversion Route	—
Manhole	●
Cone	●